

CAST-IN-PLACE CONC. CURB

LITETOP INTENSIVE GROWING MEDIA

SYSTEMFILTER

GARDENDRAIN GR50 (FILLED W/LT.WT. AGG.)

CONCRETE PAVER SET ON FIXED HEIGHT PEDESTAL OR OTHER APPROPRIATE SURFACING

DOW STYROFOAM INSULATION (OPTIONAL)

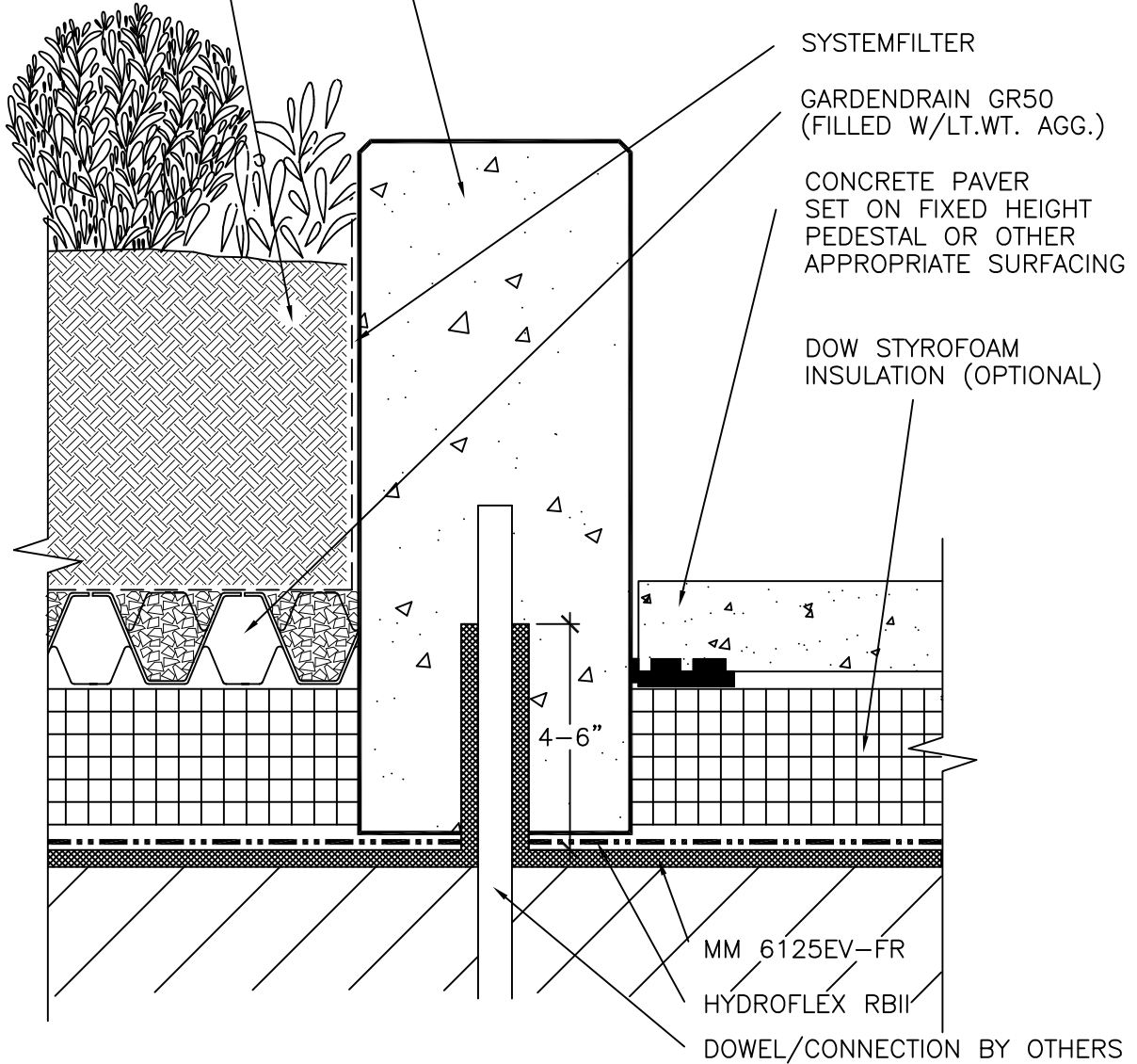

NOTES:

- FIXED HEIGHT AND ADJUSTABLE PEDESTALS NECESSARY FOR AN OPEN-JOINT PAVER INSTALLATION CANNOT BE INSTALLED OVER GARDENDRAIN. THE GARDEN ROOF AND ULTIMATE ASSEMBLY INSTALLATIONS SHOULD BE DIVIDED.
- IF GARDENDRAIN ELEMENTS ARE INSTALLED UNDER HARDSCAPE AREAS THE CUPS MUST BE FILLED WITH LIGHTWEIGHT EXPANDED AGGREGATE. GARDENDRAIN MAY ALSO BE USED AS FORMS FOR SETTING CONCRETE FOOTINGS FOR CURBS, ETC.
- REFER TO APPLICABLE MM 6125-FR ROOFING OR WATERPROOFING GUIDELINE DETAILS FOR PROPER MEMBRANE/FLASHING DETAILS AND ALTERNATIVES.



**GARDEN
ROOF
ASSEMBLY**

AMERICAN HYDROTECH, INC.

POSSIBLE TRANSITION OPTION
- CAST-IN-PLACE CURB -
(INTENSIVE APPLICATION DEPICTED)

NO SCALE

GA-5D